

Drawing AlloSure Specimens

1 COMPLETE LABELS

- A On the Tube & Accession Labels card, complete the two tube labels.

2 DRAW BLOOD

- A Check the expiration dates on both Streck tubes.
- B Fill both tubes completely. Follow the draw order shown to the right.*
- C Mix by gentle inversion.
- D Place a completed tube label lengthwise on each tube; do not cover expiration date.

3 PREPARE ORDER FORM

- A From the Tube & Accession Labels card, place the first white barcode label on the upper right corner of the order form/AlloSure Test Requisition Form.
- B If using the AlloSure Test Requisition Form, fill in:
 - patient's name
 - date of birth
 - prescriber name
 - transplant center
 - draw date
 - phlebotomist initials

4 PACKING THE SPECIMENS

- A Place the tubes in the absorbent pouch and place pouch in the 95 kPa bag and seal.
- B Wrap the 95 kPa bag in the gel.
- C Place gel wrap in foil envelope and seal.
- D Place envelope in shipper box. Place the order form and Tube & Accession Labels card on top of envelope. Place List of Contents card on top.
- E Close and seal the shipper box.
- F Place the box inside the labeled FedEx shipping envelope. Seal and send.

5 STORAGE & SHIPMENT

- A Store specimens between 6° and 37° C until shipping.
- B Contact FedEx for same day pickup, or drop the specimens at the nearest FedEx facility.

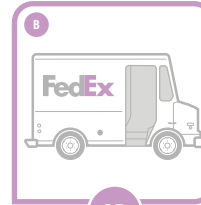
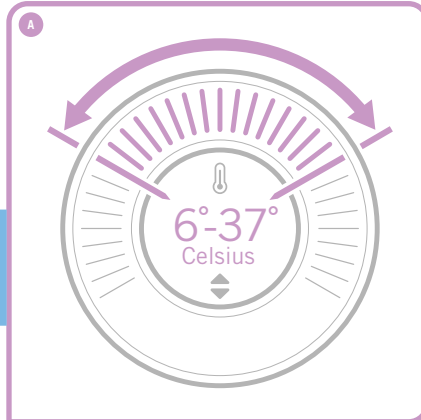
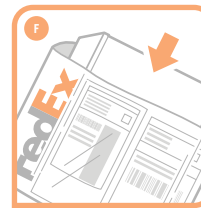
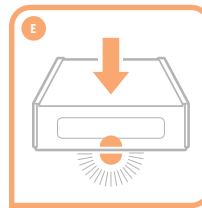
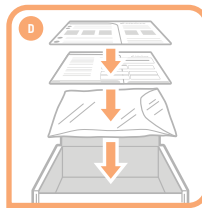
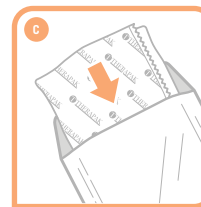
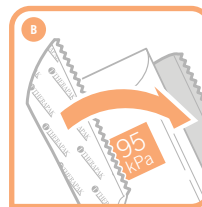
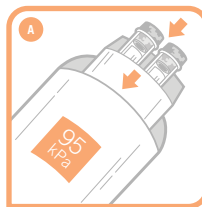
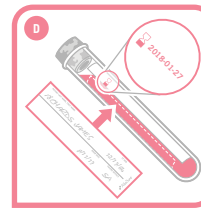
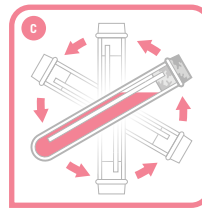
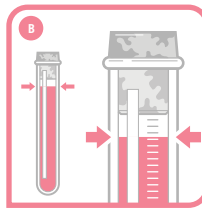
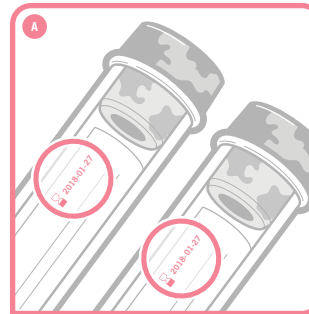
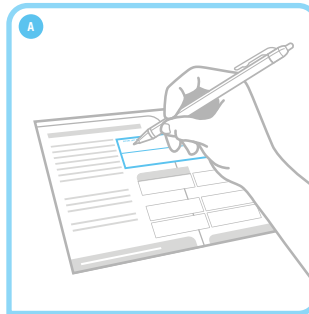

* DRAW ORDER

This is the draw order to be followed for AlloSure testing.

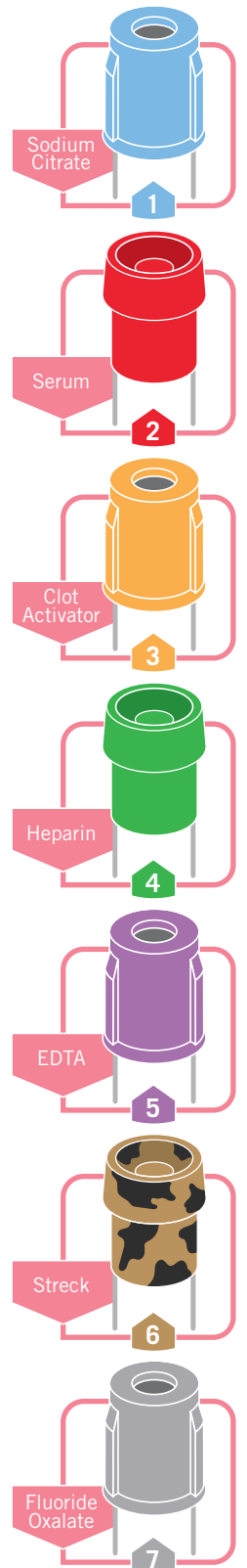

Questions? Contact:
 customercare@careDX.com • 1-888-255-6627

